

USER AND MAINTENANCE MANUAL

ECONOMIC SPREADER BEAMS

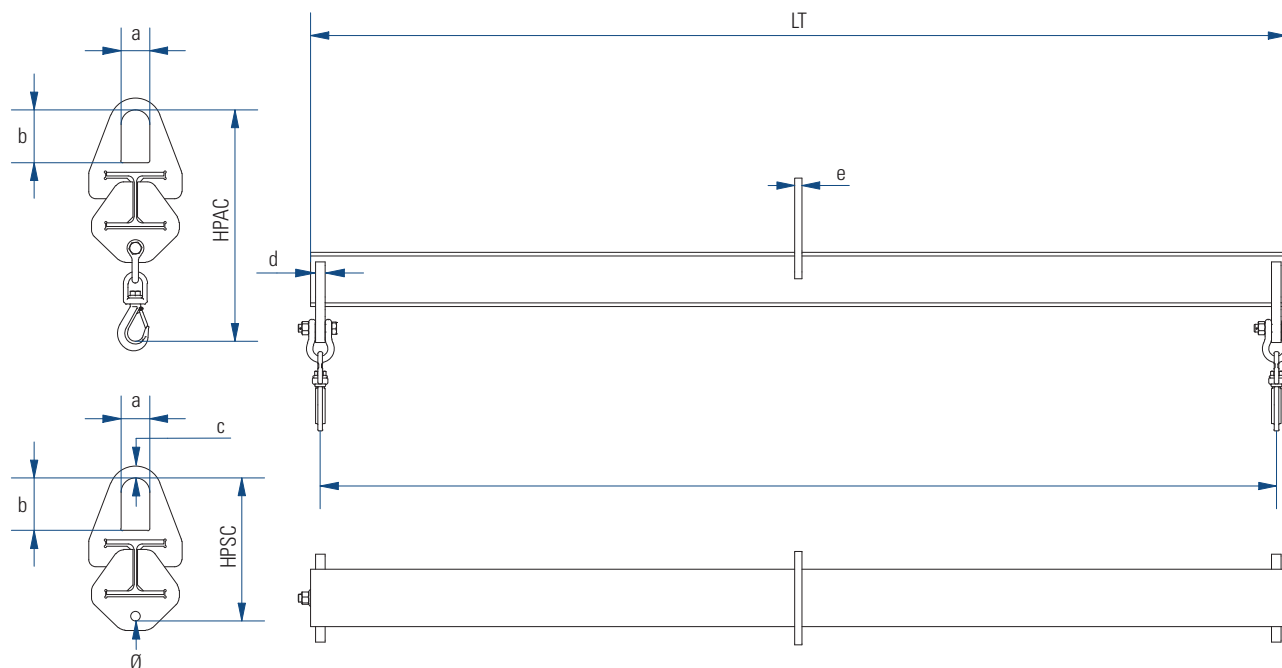

FIXED ECO LIFTING BEAMS



LT	Longueur Totale	Total length
HPAC	Hauteur perdue avec crochets	Headroom with hooks
HPSC	Hauteur perdue sans crochet	Headroom without hook

DESCRIPTIF

- Palonnier fixe type ECO.
- Protection : grenailage SA 2.5 + peinture poudre polyester 60 microns C2.
- Finition jaune RAL 1028.
- Coefficient de sécurité = 2.
- Aucune soudure portante.
- Fabrication selon norme NF EN 13155-2.
- Groupe = FEM5.
- $\alpha = 5^{\circ}50'$.
- Vitesse de levage = 16 m/min maxi.
- Livré avec notice d'utilisation et d'entretien et certificat de conformité CE.
- Pour capacités supérieures, nous consulter.

OPTIONS

- Équipé de 2 crochets tournants articulés avec linguets de sécurité forgés.
- Réglage des crochets par suspentes déplaçables.

DESCRIPTION

- Fixed spreader beam.
- Protection: grinding SA 2.5 + polyester powder painting 60 micron C2.
- RAL 1028 yellow finish.
- Safety factor: 2
- No structural weld.
- Manufactured according to standard NF EN 13155-2.
- Group = FEM5.
- $\alpha = 5^{\circ}50'$.
- Maximum hoisting speed = 16m/min.
- Delivered with user's and maintenance manual and EC certificate of compliance.
- For superior capacities, contact us.

OPTIONS

- Equipped with 2 articulated, rotating hooks with forged safety latches.
- Adjustment of the hooks with movable hangers.

FIXED ECO LIFTING BEAMS

CMU	Longueur entre crochets (L)	Longueur Totale (LT)	Épaisseur suspente (d)	Épaisseur anse (e)	Hauteur perdue avec crochet (HPAC)	Hauteur perdue sans crochet (HPSC)	a	b	c	Ø perçage	Poids
Max. capacity	Length between hooks (L)	Total length (LT)	Thickness hanger (d)	Thickness handle (e)	Headroom with hook (HPAC)	Headroom without hook (HPSC)				Ø drilling	Weight
kg	mm	mm	mm	mm	mm	mm	mm	mm	mm	mm	Kg
1 000	1 000	1040	20	15	484	299	60	110	25	18	30
	2 000	2040	20	15	484	299	60	110	25	18	50
	3 000	3040	20	15	484	299	60	110	25	18	70
	4 000	4040	20	15	484	299	60	110	25	18	90
	5 000	5040	20	15	532	347	60	110	25	18	164
	6 000	6040	20	15	532	347	60	110	25	18	194
2 000	1 000	1040	20	15	484	299	60	110	25	18	30
	2 000	2040	20	15	484	299	60	110	25	18	50
	3 000	3040	20	15	532	347	60	110	25	18	103
	4 000	4040	20	15	532	347	60	110	25	18	134
	5 000	5040	20	15	580	185	60	110	25	18	228
	6 000	6040	20	15	580	185	60	110	25	18	270
3 200	1 000	1040	20	20	548	339	80	140	40	18	32
	2 000	2040	20	20	596	387	80	140	40	18	75
	3 000	3045	20	20	644	435	80	140	40	18	147
	4 000	4040	20	20	644	435	80	140	40	18	189
	5 000	5040	20	20	644	435	80	140	40	18	231
	6 000	6040	20	20	654	445	80	140	40	18	324
4 000	1 000	1045	25	20	563	339	80	140	40	20	34
	2 000	2045	25	20	611	390	80	140	40	20	78
	3 000	3045	25	20	679	458	80	140	40	20	151
	4 000	4045	25	20	679	458	80	140	40	20	228
	5 000	5045	25	20	679	458	80	140	40	20	279
	6 000	6045	25	20	714	493	80	140	40	20	395
5 000	1 000	1045	25	25	696	430	100	180	50	20	54
	2 000	2045	25	25	764	498	100	180	50	20	115
	3 000	3045	25	25	764	498	100	180	50	20	157
	4 000	4045	25	25	764	498	100	180	50	20	228
	5 000	5045	25	25	799	533	100	180	50	20	340
	6 000	6045	25	25	819	553	100	180	50	20	450
6 300	1 000	1050	30	25	710	430	100	180	50	24	56
	2 000	2050	30	25	778	498	100	180	50	24	119
	3 000	3050	30	25	798	518	100	180	50	24	190
	4 000	4050	30	25	818	538	100	180	50	24	286
	5 000	5050	30	25	838	558	100	180	50	24	387
	6 000	6050	30	25	858	578	100	180	50	24	509
8 000	1 000	1050	30	35	824	518	100	180	50	24	95
	2 000	2050	30	35	824	518	100	180	50	24	145
	3 000	3050	30	35	844	538	100	180	50	24	232
	4 000	4050	30	35	864	558	100	180	50	24	326
	5 000	5050	30	35	884	578	100	180	50	24	440
	6 000	6050	30	35	904	598	100	180	50	24	594
10 000	1 000	1055	35	35	843	531	100	180	50	26	101
	2 000	2055	35	35	863	551	100	180	50	26	179
	3 000	3055	35	35	883	571	100	180	50	26	267
	4 000	4055	35	35	903	591	100	180	50	26	372
	5 000	5055	35	35	923	611	100	180	50	26	514
	6 000	6055	35	35	963	651	100	180	50	26	701

ADJUSTABLE ECO LIFTING BEAMS

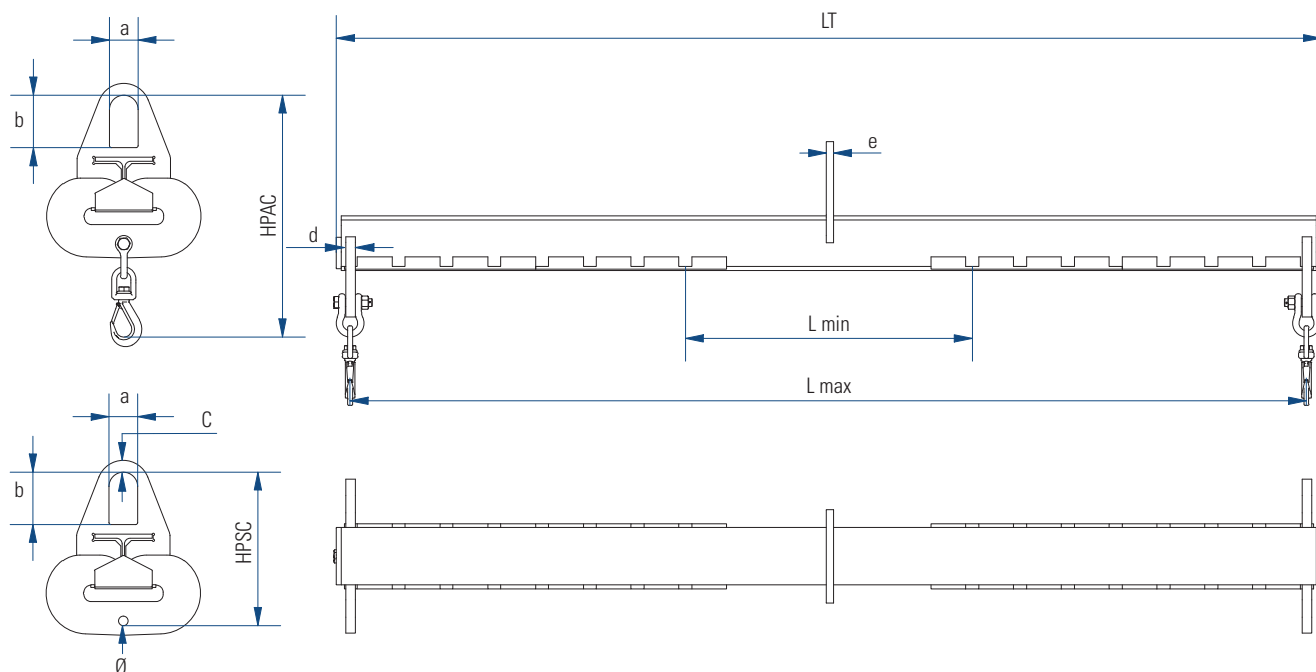

LT	Longueur Totale	Total length
HPAC	Hauteur perdue avec crochets	Headroom with hooks
HPSC	Hauteur perdue sans crochet	Headroom without hook
P	Pas = 100 mm	Pitch = 100mm
HP	Hauteur perdue	Headroom
L min	Longueur mini entre crochets	Min. length between hooks
L max	Longueur maxi entre crochets	Max. length between hooks

DESCRIPTIF

- Palonnier réglable type ECO.
- Œillet antidéchirement pour utilisation avec élingues synthétiques, câbles...
- Protection : grenailage SA 2.5 + peinture poudre polyester 60 microns C2.
- Finition jaune RAL 1028.
- Coefficient de sécurité = 2.
- Aucune soudure portante.
- Fabrication selon norme NF EN 13155-2.
- Groupe = FEM5.
- $\alpha = 5^{\circ}50'$.
- Réglage au pas = 100 mm.
- Vitesse de levage = 16 m / min maxi.
- Livré avec notice d'utilisation et d'entretien et certificat de conformité CE.
- Pour capacités supérieures, nous consulter.

OPTIONS

- Équipé de 2 crochets tournants articulés avec linguets de sécurité forgés.
- Réglage des crochets par suspentes déplaçables.

DESCRIPTION

- Adjustable spreader beam.
- Tear-resistant eyelet for use with synthetic slings, cables, etc.
- Protection: grinding SA 2.5 + polyester powder painting 60 micron C2.
- RAL 1028 yellow finish.
- Safety factor: 2.
- No structural weld.
- Manufactured according to standard NF EN 13155-2.
- Group = FEM5.
- $\alpha = 5^{\circ}50'$.
- Pitch = 100mm.
- Maximum hoisting speed = 16m / min.
- Delivered with user's and maintenance manual and EC certificate of compliance.
- For superior capacities, contact us.

OPTIONS

- Equipped with 2 articulated, rotating hooks with forged safety latches.
- Adjustment of the hooks with movable hangers.

ADJUSTABLE ECO LIFTING BEAMS

CMU	Longueur maxi entre crochets (L)	Longueur mini entre crochets (Lmin)	Épaisseur suspenste (d)	Épaisseur anse (e)	Longueur Totale (LT)	Pas (P)	Hauteur perdue avec crochet (HPAC)	Hauteur perdue sans crochet (HPSC)	a	b	c	Ø perçage	Poids
Max. capacity	Length max. between hooks (L)	Length min. between hooks (Lmin)	Thickness hanger (d)	Thickness handle (e)	Total length (LT)	Step (P)	Headroom with hook (HPAC)	Headroom without hook (HPSC)				Ø drilling	Weight
kg	mm	mm	mm	mm	mm	mm	mm	mm	mm	mm	mm	mm	Kg
1000	1 000	500	20	15	1 060	50	506	321	60	110	25	20	38
	2 000	1 000	20	15	2 060	100	506	321	60	110	25	20	61
	3 000	1 000	20	15	3 060	100	506	321	60	110	25	20	83
	4 000	2 000	20	15	4 060	100	506	321	60	110	25	20	102
	5 000	3 000	20	15	5 060	100	553	368	60	110	25	20	182
	6 000	4 000	20	15	6 060	100	553	368	60	110	25	20	211
2000	1 000	500	20	15	1 060	50	530	321	60	110	25	20	39
	2 000	1 000	20	15	2 060	100	530	321	60	110	25	20	62
	3 000	1 000	20	15	3 060	100	577	368	60	110	25	20	121
	4 000	2 000	20	15	4 060	100	577	368	60	110	25	20	151
	5 000	3 000	20	15	5 060	100	624	415	60	110	25	20	246
	6 000	4 000	20	15	6 060	100	624	415	60	110	25	20	288
3200	1 000	500	20	20	1 060	50	630	361	80	140	40	20	41
	2 000	1 000	20	20	2 060	100	677	408	80	140	40	20	91
	3 000	1 000	20	20	3 065	100	724	455	80	140	40	20	164
	4 000	2 000	20	20	4 060	100	724	455	80	140	40	20	206
	5 000	3 000	20	20	5 060	100	724	455	80	140	40	20	249
	6 000	4 000	20	20	6 060	100	733	464	80	140	40	20	359
4000	1 000	500	25	20	1 065	50	673	367	80	140	40	20	47
	2 000	1 000	25	20	2 065	100	720	414	80	140	40	24	96
	3 000	1 000	25	20	3 065	100	784	478	80	140	40	24	174
	4 000	2 000	25	20	4 065	100	783	477	80	140	40	24	249
	5 000	3 000	25	20	5 065	100	783	477	80	140	40	24	300
	6 000	4 000	25	20	6 065	100	817	511	80	140	40	24	411
5000	1 000	500	25	25	1 065	50	760	454	100	180	50	24	68
	2 000	1 000	25	25	2 065	100	824	518	100	180	50	24	136
	3 000	1 000	25	25	3 065	100	824	518	100	180	50	24	180
	4 000	2 000	25	25	4 065	100	823	517	100	180	50	24	255
	5 000	3 000	25	25	5 065	100	857	551	100	180	50	24	356
	6 000	4 000	25	25	6 065	100	877	571	100	180	50	24	472
6300	1 000	500	30	25	1 070	50	760	454	100	180	50	24	72
	2 000	1 000	30	25	2 070	100	824	518	100	180	50	24	142
	3 000	1 000	30	25	3 070	100	843	537	100	180	50	26	218
	4 000	2 000	30	25	4 070	100	862	556	100	180	50	26	313
	5 000	3 000	30	25	5 070	100	882	576	100	180	50	26	413
	6 000	4 000	30	25	6 070	100	901	595	100	180	50	26	534
8000	1 000	500	30	35	1 070	50	892	537	100	180	50	26	119
	2 000	1 000	30	35	2 070	100	892	537	100	180	50	26	172
	3 000	1 000	30	35	3 070	100	911	556	100	180	50	26	260
	4 000	2 000	30	35	4 070	100	931	576	100	180	50	26	355
	5 000	3 000	30	35	5 070	100	917	595	100	180	50	26	465
	6 000	4 000	30	35	6 070	100	969	614	100	180	50	26	612
10000	1 000	500	35	35	1 075	50	916	550	100	180	50	30	130
	2 000	1 000	35	35	2 075	100	935	569	100	180	50	30	209
	3 000	1 000	35	35	3 075	100	949	584	100	180	50	30	298
	4 000	2 000	35	35	4 075	100	974	609	100	180	50	30	404
	5 000	3 000	35	35	5 075	100	993	627	100	180	50	30	539
	6 000	4 000	35	35	6 075	100	1 030	665	100	180	50	30	731

IINDEX

1. GUARANTEE	4
2. RECEPTION AND STORAGE	4
3. INSTALLATION AND USE	4
4. MANDATORY CHECKS	6
5. WARNING	6
6. NOMENCLATURE	7

1. GUARANTEE

- The normal warranty covers a period of 1 year. This period can be converted into hours of use depending on the type of equipment or its operating class.
- It starts from the day of delivery and ends at the earlier of the period of 1 year or the period of use.

2. RECEPTION AND STORAGE

- On arrival of the product, visually inspect the packaging to ensure that it is in good condition. In case of anomaly, make the usual reservations.
- Check that the product corresponds to your order.
- The packaged product should be stored in a sheltered, dry place.
- The product must be unpacked using appropriate tools without damaging the product. The packaging must be disposed of.
- Once unpacked, the spreader should be stored in a dry, sheltered place to avoid any risk of damage to the product.

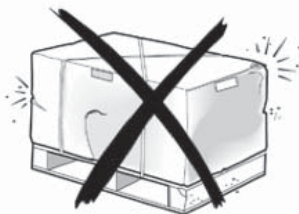

3. INSTALLATION AND USE

- The spreader is a piece of equipment consisting of one or more beams equipped with attachment points to facilitate the handling of loads that need to be held at several points.
- The spreader bar shall be attached to a hook with an effective safety catch. The gripping eye shall be fully engaged in the hook.

CORRECT

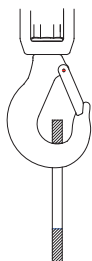

BAD

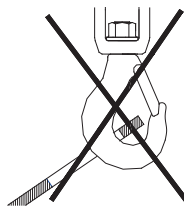

- If the hook for gripping the spreader bar is too large for the spreader bar's gripping eye, a suitable intermediate attachment can be used. In this case, check that it is suitable for the load plus the weight of the spreader bar.
- When calculating the total load to be lifted, take into account the dead weight of the lifting beam (indicated on the nameplate) so as not to exceed the capacity of the lifting device intended to handle the assembly.
- Also check that the lines are stable before loading.
- Slinging at the bottom must be carried out under the following conditions :

CORRECT

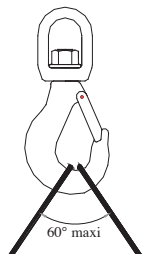

BAD

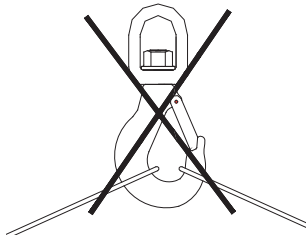

CORRECT

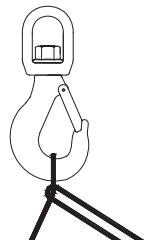

- When in use, the spreader bar should be close to the horizontal. In case of tilting, stop the lifting and unhook the load to find the correct setting of the hooking points.

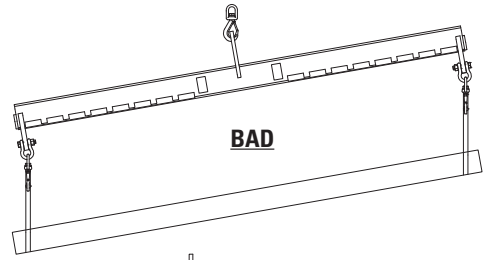
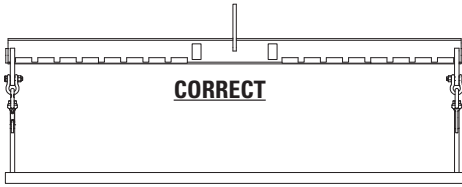

- Check that the slinging angle at the bottom does not exceed an angle $\alpha = 6^\circ$

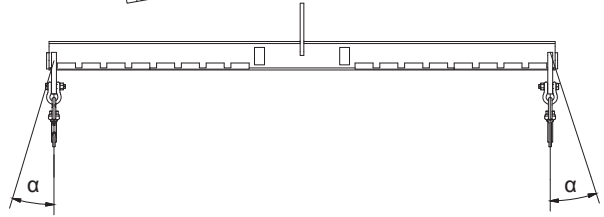

The user should be aware of and adhere to certain methods of securing the load, so as to enable the user to ensure that the spreader-load assembly is stable when lifted :

In the case of a spreader bar and a load with a positive stability height, the spreader bar plus load will always be stable regardless of the values **A** and **B** **POSITIVE**.

Secondly, in the case of a spreader bar with a positive stability height carrying a load with a negative stability height (the hooking point is located below the centre of gravity). The spreader-load assembly will be stable when the spreader's stability height is greater than the load's stability height.

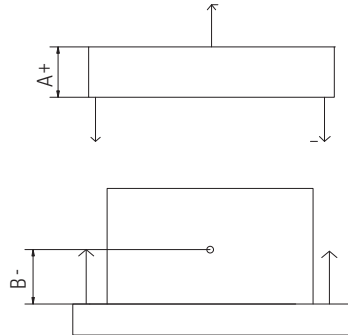
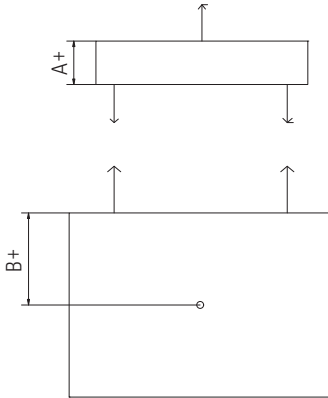

When $A > B \rightarrow$ STABLE

When $A < B \rightarrow$ INSTABLE

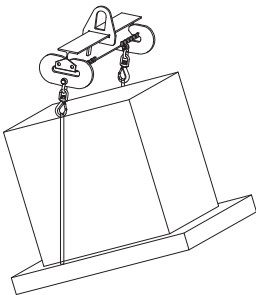

LOWERING

4. MANDATORY CHECKS

- Carry out a check when the spreader is put into service by a qualified body in accordance with the order of 1 March 2004.
- Carry out periodic checks in accordance with the order of 1 March 2004.
- A thorough inspection must be carried out to detect any defects caused by impact, cracks, deformation or corrosion. This inspection must be carried out at least twice a year.

Before each use :

- Carry out a visual inspection and check that the equipment is working properly.
- Check the correct display of the maximum load.
- Check the appearance and functioning of the safety latches.
- Ensure that all the components of the spreader bar are present.
- Any defective part must be removed from service immediately.
- Lightly oil the supports of the rotary hooks.

5. WARNING

- EPI must be worn during use.



- A visual inspection of the welds, fasteners or suspension parts must be carried out.
- Check the condition of accessories such as slings, hooks, shackles and their compatibility with the spreader.
- Operating temperature : -20° to +90°
- Do not modify the product as this may damage it.
- Do not couple other materials than those recommended
- Do not use the spreader bar for any purpose other than its primary function.
- Any equipment that has been overloaded must be removed from service immediately.
- Do not exceed the **MAXIMUM CAPACITY (SWL)** indicated on the spreader bar.
- Do not use sharp objects or objects that could damage the hooks.
- Do not stand under loads.
- Do not hook a load below the centre of gravity.
- Handling with a spreader bar should be dangerous. Staff must be informed of the risks and safety rules.

6. NOMENCLATURE

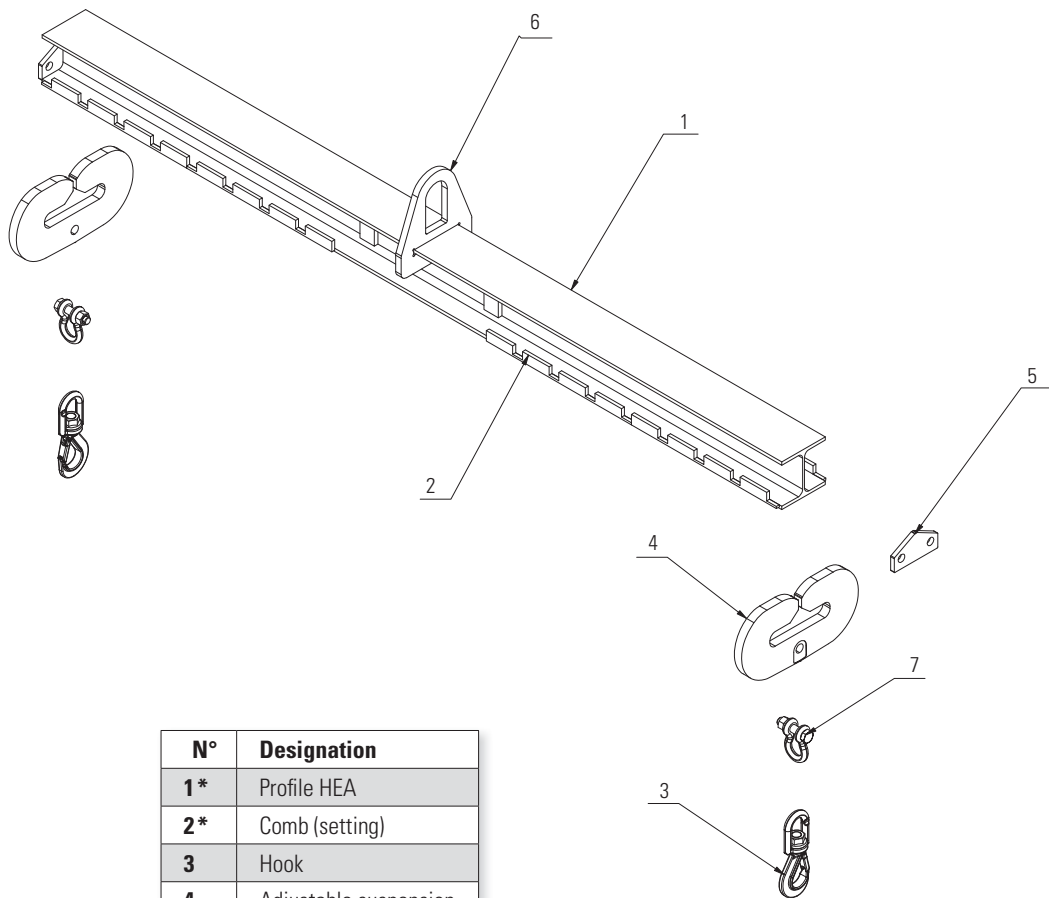

N°	Designation
1*	Profile HEA
2*	Comb (setting)
3	Hook
4	Adjustable suspension
5*	Stop plate
6*	Cove
7	Manille

* Inseparable elements.

For technical specifications, please refer to the data sheet.

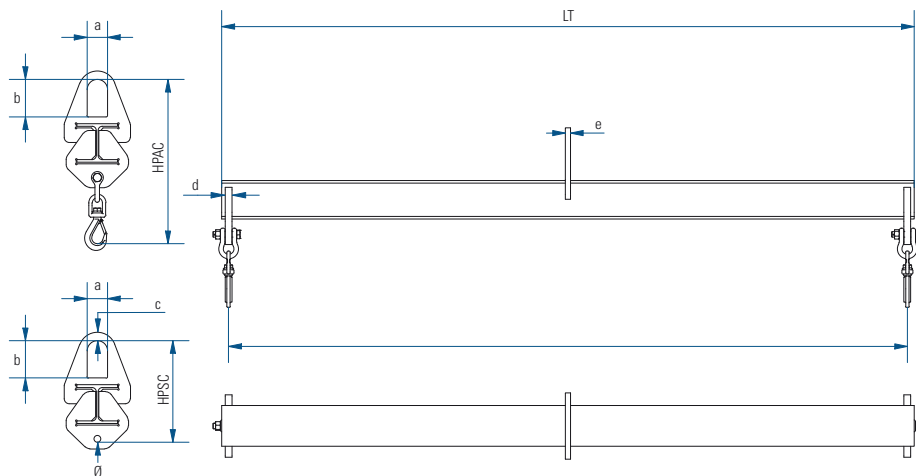

LT	Longueur Totale	Total length
HPAC	Hauteur perdue avec crochets	Headroom with hooks
HPSC	Hauteur perdue sans crochet	Headroom without hook

DESCRIPTIF

- Palonnier fixe type ECO.
- Protection : grenailage SA 2.5 + peinture poudre polyester 60 microns C2.
- Finition jaune RAL 1028.
- Coefficient de sécurité = 2.
- Aucune soudure portante.
- Fabrication selon norme NF EN 13155-2.
- Groupe = FEMS.
- $\alpha = 5^{\circ}50'$.
- Vitesse de levage = 16 m/min maxi.
- Livré avec notice d'utilisation et d'entretien et certificat de conformité CE.
- Pour capacités supérieures, nous consulter.

OPTIONS

- Équipé de 2 crochets tournants articulés avec linguets de sécurité forgés.
- Réglage des crochets par suspentes déplaçables.

DESCRIPTION

- Fixed spreader beam.
- Protection: grinding SA 2.5 + polyester powder painting 60 micron C2.
- RAL 1028 yellow finish.
- Safety factor: 2
- No structural weld.
- Manufactured according to standard NF EN 13155-2.
- Group = FEMS.
- $\alpha = 5^{\circ}50'$.
- Maximum hoisting speed = 16m/min.
- Delivered with user's and maintenance manual and EC certificate of compliance.
- For superior capacities, contact us.

OPTIONS

- Equipped with 2 articulated, rotating hooks with forged safety latches.
- Adjustment of the hooks with movable hangers.

CMU	Longueur entre crochets (L)	Longueur Totale (LT)	Épaisseur suspente (d)	Épaisseur anse (e)	Hauteur perdue avec crochet (HPAC)	Hauteur perdue sans crochet (HPSC)	a	b	c	Ø perçage	Poids
	Max. capacity	Length between hooks (L)	Total length (LT)	Thickness hanger (d)	Thickness handle (e)	Headroom with hook (HPAC)				Headroom without hook (HPSC)	
kg	mm	mm	mm	mm	mm	mm	mm	mm	mm	mm	Kg
1 000	1 000	1040	20	15	484	299	60	110	25	18	30
	2 000	2040	20	15	484	299	60	110	25	18	50
	3 000	3040	20	15	484	299	60	110	25	18	70
	4 000	4040	20	15	484	299	60	110	25	18	90
	5 000	5040	20	15	532	347	60	110	25	18	164
	6 000	6040	20	15	532	347	60	110	25	18	194
2 000	1 000	1040	20	15	484	299	60	110	25	18	30
	2 000	2040	20	15	484	299	60	110	25	18	50
	3 000	3040	20	15	532	347	60	110	25	18	103
	4 000	4040	20	15	532	347	60	110	25	18	134
	5 000	5040	20	15	580	185	60	110	25	18	228
	6 000	6040	20	15	580	185	60	110	25	18	270
3 200	1 000	1040	20	20	548	339	80	140	40	18	32
	2 000	2040	20	20	596	387	80	140	40	18	75
	3 000	3045	20	20	644	435	80	140	40	18	147
	4 000	4040	20	20	644	435	80	140	40	18	189
	5 000	5040	20	20	644	435	80	140	40	18	231
	6 000	6040	20	20	654	445	80	140	40	18	324
4 000	1 000	1045	25	20	563	339	80	140	40	20	34
	2 000	2045	25	20	611	390	80	140	40	20	78
	3 000	3045	25	20	679	458	80	140	40	20	151
	4 000	4045	25	20	679	458	80	140	40	20	228
	5 000	5045	25	20	679	458	80	140	40	20	279
	6 000	6045	25	20	714	493	80	140	40	20	395
5 000	1 000	1045	25	25	696	430	100	180	50	20	54
	2 000	2045	25	25	764	498	100	180	50	20	115
	3 000	3045	25	25	764	498	100	180	50	20	157
	4 000	4045	25	25	764	498	100	180	50	20	228
	5 000	5045	25	25	799	533	100	180	50	20	340
	6 000	6045	25	25	819	553	100	180	50	20	450
6 300	1 000	1050	30	25	710	430	100	180	50	24	56
	2 000	2050	30	25	778	498	100	180	50	24	119
	3 000	3050	30	25	798	518	100	180	50	24	190
	4 000	4050	30	25	818	538	100	180	50	24	286
	5 000	5050	30	25	838	558	100	180	50	24	387
	6 000	6050	30	25	858	578	100	180	50	24	509
8 000	1 000	1050	30	35	824	518	100	180	50	24	95
	2 000	2050	30	35	824	518	100	180	50	24	145
	3 000	3050	30	35	844	538	100	180	50	24	232
	4 000	4050	30	35	864	558	100	180	50	24	326
	5 000	5050	30	35	884	578	100	180	50	24	440
	6 000	6050	30	35	904	598	100	180	50	24	584
10 000	1 000	1055	35	35	843	531	100	180	50	26	101
	2 000	2055	35	35	863	551	100	180	50	26	179
	3 000	3055	35	35	883	571	100	180	50	26	267
	4 000	4055	35	35	903	591	100	180	50	26	372
	5 000	5055	35	35	923	611	100	180	50	26	514
	6 000	6055	35	35	963	651	100	180	50	26	701

ADJUSTABLE ECO LIFTING BEAMS

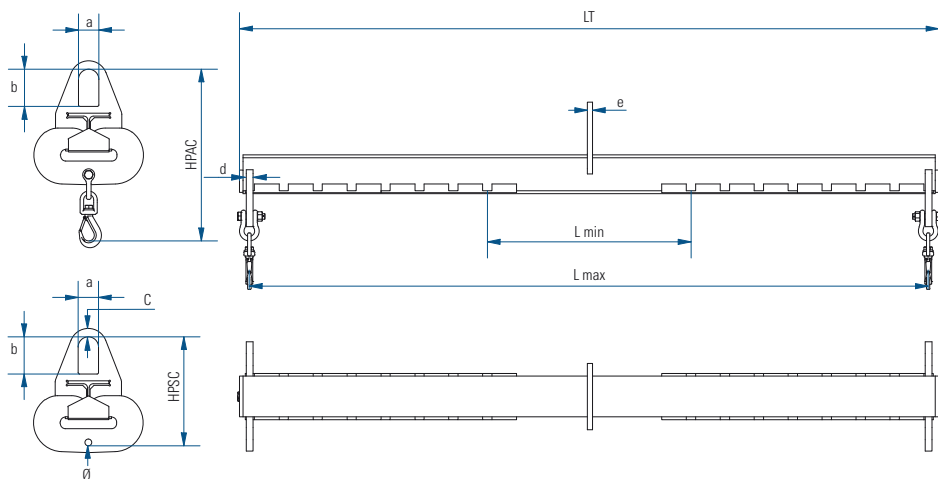

LT	Longueur Totale	Total length
HPAC	Hauteur perdue avec crochets	Headroom with hooks
HPSC	Hauteur perdue sans crochet	Headroom without hook
P	Pas = 100 mm	Pitch = 100mm
HP	Hauteur perdue	Headroom
L min	Longueur mini entre crochets	Min. length between hooks
L max	Longueur maxi entre crochets	Max. length between hooks

DESCRIPTIF

- Palonnier réglable type ECO.
- Cillet antidéchirement pour utilisation avec élingues synthétiques, câbles...
- Protection : grenailage SA 2.5 + peinture poudre polyester 60 microns C2.
- Finition jaune RAL 1028.
- Coefficient de sécurité = 2.
- Aucune soudure portante.
- Fabrication selon norme NF EN 13155-2.
- Groupe = FEM5.
- $\alpha = 5^{\circ}50'$.
- Réglage au pas = 100 mm.
- Vitesse de levage = 16 m / min maxi.
- Livré avec notice d'utilisation et d'entretien et certificat de conformité CE.
- Pour capacités supérieures, nous consulter.

OPTIONS

- Équipé de 2 crochets tournants articulés avec linguets de sécurité forgés.
- Réglage des crochets par suspentes déplaçables.

DESCRIPTION

- Adjustable spreader beam.
- Tear-resistant eyelet for use with synthetic slings, cables, etc.
- Protection: grinding SA 2.5 + polyester powder painting 60 micron C2.
- RAL 1028 yellow finish.
- Safety factor: 2.
- No structural weld.
- Manufactured according to standard NF EN 13155-2.
- Group = FEM5.
- $\alpha = 5^{\circ}50'$.
- Pitch = 100mm.
- Maximum hoisting speed = 16m / min.
- Delivered with user's and maintenance manual and EC certificate of compliance.
- For superior capacities, contact us.

OPTIONS

- Equipped with 2 articulated, rotating hooks with forged safety latches.
- Adjustment of the hooks with movable hangers.

PALONNIERS ECO RÉGLABLES
ADJUSTABLE ECO LIFTING BEAMS

CMU	Longueur maxi entre crochets (L)	Longueur mini entre crochets (Lmin)	Épaisseur suspente (d)	Épaisseur anse (e)	Longueur Totale (LT)	Pas (P)	Hauteur perdue avec crochet (HPAC)	Hauteur perdue sans crochet (HPSC)	a	b	c	Ø perçage	Poids
Max. capacity	Length max. between hooks (L)	Length min. between hooks (Lmin)	Thickness hanger (d)	Thickness handle (e)	Total length (LT)	Step (P)	Headroom with hook (HPAC)	Headroom without hook (HPSC)				Ø drilling	Weight
kg	mm	mm	mm	mm	mm	mm	mm	mm	mm	mm	mm	mm	Kg
1000	1 000	500	20	15	1 060	50	506	321	60	110	25	20	38
	2 000	1 000	20	15	2 060	100	506	321	60	110	25	20	61
	3 000	1 000	20	15	3 060	100	506	321	60	110	25	20	83
	4 000	2 000	20	15	4 060	100	506	321	60	110	25	20	102
	5 000	3 000	20	15	5 060	100	553	368	60	110	25	20	182
	6 000	4 000	20	15	6 060	100	553	368	60	110	25	20	211
2000	1 000	500	20	15	1 060	50	530	321	60	110	25	20	39
	2 000	1 000	20	15	2 060	100	530	321	60	110	25	20	62
	3 000	1 000	20	15	3 060	100	577	368	60	110	25	20	121
	4 000	2 000	20	15	4 060	100	577	368	60	110	25	20	151
	5 000	3 000	20	15	5 060	100	624	415	60	110	25	20	246
	6 000	4 000	20	15	6 060	100	624	415	60	110	25	20	288
3200	1 000	500	20	20	1 060	50	630	361	80	140	40	20	41
	2 000	1 000	20	20	2 060	100	677	408	80	140	40	20	91
	3 000	1 000	20	20	3 065	100	724	455	80	140	40	20	164
	4 000	2 000	20	20	4 060	100	724	455	80	140	40	20	206
	5 000	3 000	20	20	5 060	100	724	455	80	140	40	20	249
	6 000	4 000	20	20	6 060	100	733	464	80	140	40	20	359
4000	1 000	500	25	20	1 065	50	673	367	80	140	40	20	47
	2 000	1 000	25	20	2 065	100	720	414	80	140	40	24	96
	3 000	1 000	25	20	3 065	100	784	478	80	140	40	24	174
	4 000	2 000	25	20	4 065	100	783	477	80	140	40	24	249
	5 000	3 000	25	20	5 065	100	783	477	80	140	40	24	300
	6 000	4 000	25	20	6 065	100	817	511	80	140	40	24	411
5000	1 000	500	25	25	1 065	50	760	454	100	180	50	24	68
	2 000	1 000	25	25	2 065	100	824	518	100	180	50	24	136
	3 000	1 000	25	25	3 065	100	824	518	100	180	50	24	180
	4 000	2 000	25	25	4 065	100	823	517	100	180	50	24	255
	5 000	3 000	25	25	5 065	100	857	551	100	180	50	24	356
	6 000	4 000	25	25	6 065	100	877	571	100	180	50	24	472
6300	1 000	500	30	25	1 070	50	760	454	100	180	50	24	72
	2 000	1 000	30	25	2 070	100	824	518	100	180	50	24	142
	3 000	1 000	30	25	3 070	100	843	537	100	180	50	26	218
	4 000	2 000	30	25	4 070	100	862	556	100	180	50	26	313
	5 000	3 000	30	25	5 070	100	882	576	100	180	50	26	413
	6 000	4 000	30	25	6 070	100	901	595	100	180	50	26	534
8000	1 000	500	30	35	1 070	50	892	537	100	180	50	26	119
	2 000	1 000	30	35	2 070	100	892	537	100	180	50	26	172
	3 000	1 000	30	35	3 070	100	911	556	100	180	50	26	260
	4 000	2 000	30	35	4 070	100	931	576	100	180	50	26	355
	5 000	3 000	30	35	5 070	100	917	595	100	180	50	26	465
	6 000	4 000	30	35	6 070	100	969	614	100	180	50	26	612
10000	1 000	500	35	35	1 075	50	916	550	100	180	50	30	130
	2 000	1 000	35	35	2 075	100	935	569	100	180	50	30	209
	3 000	1 000	35	35	3 075	100	949	584	100	180	50	30	298
	4 000	2 000	35	35	4 075	100	974	609	100	180	50	30	404
	5 000	3 000	35	35	5 075	100	993	627	100	180	50	30	539
	6 000	4 000	35	35	6 075	100	1 030	665	100	180	50	30	731